

THE CITY OF NAPOLEON

BUILDING & ZONING DEPARTMENT

255 W. RIVERVIEW

(419)592-4010

Building Permit

Page 1 of 1

Permit Number: BP2005-113

Printed: 7/27/2005

Property Address: 223 Garden St.

Applicant Mock Buehrer Builders
Address: P-707 Co. Rd. 16
Napoleon, OH 43545

Approval Date: 7/27/2005

Phone: 419-592-0825

Owners

Name: Mock-Buehrer Builders
Address: P707 Co Rd 16

Phone: 419-592-0825

Contractors Mock Buehrer Builders
Address: P-707 Co. Rd. 16
Napoleon, OH 43545

Phone 419-592-0825

Contractors Irving, Chuck Jr
Address: 324 W Maple St
Liberty Center, OH 43532

Phone 419-261-6381

Fees and Receipts:

Number	Description	Amount
FEE2005-552	New building permit fee (Auto)	\$220.30
Total Fees:		\$220.30

Description

Structure Use:

Start Date: 7/25/2005

Construction Value: \$87,500.00

End Date:

Floor Areas

Living Space: 1352 1,352.00

Other:

Basement/Storage:

Total Area:

Garage: 352.00

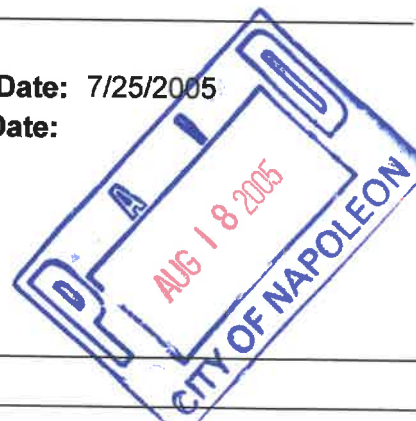

Description of work to be done: New duplex

Applicant signature: _____ **Date:** _____

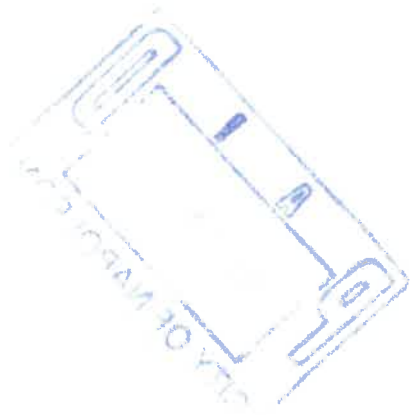

225 + 223

NEW HOME AND ADDITION PERMIT APPLICATION

THIS APPLICATION IS FOR RESIDENTIAL CONSTRUCTION INCLUDING BUILDING, ELECTRICAL, PLUMBING, MECHANICAL, DEMOLITION, REMODELING.

DATE 7/21/05 JOB LOCATION GARDEN ST.

LOT # _____ SUBDIVISION NAME _____

OWNER MOCK-BUEHRER BUILDERS PHONE 592-0825

OWNER ADDRESS P 707 CO RD 16 CITY NAP. ZIP 43545

CONTRACTOR - SAME PHONE _____

CONTRACTOR ADDRESS SAME CITY _____ ZIP _____

CONTRACTOR FAX # _____ CELL PHONE (Opt.) _____

DESCRIPTION OF WORK TO BE PERFORMED: DUPLEX

ESTIMATED COST OF WORK TO BE PERFORMED: \$175,000 %
\$87,500

WORK INFORMATION

BUILDING: Basement Floor Area _____ Sq. Ft. 1st Story Living Area 524 26 Sq. Ft.

2nd Floor Living Area _____ Sq. Ft. Garage Floor Area 16' x 22' Sq. Ft.

BUILDING SIZE: Length _____ Width _____ Stories _____ Height _____ DEMO VOL _____

Masonry Contractor IRVING MASONRY Phone _____ Fax _____
Address _____ City LIBERTY CENTER St _____ Zip _____

Electrical Contractor TOM SPEISER ELE. Phone _____ Fax _____
Address _____ City NAP. St _____ Zip _____

Plumbing Contractor MARK KNAPP Phone _____ Fax _____
Address _____ City LIBERTY CENTER St _____ Zip _____

Heating Contractor MARK KNAPP Phone _____ Fax _____
Address _____ City LIBERTY CENTER St _____ Zip _____

Insulation Contractor MOMPER Phone _____ Fax _____
Address _____ City FRANKLIN St _____ Zip _____

Other Contractor attach information.

ZONING INFORMATION (to be completed by City): District _____ Lot Dimensions _____
Lot Area 166 X 130 FRSB _____ SYSB _____ RYSB _____ Max Ht _____ ft Max Cov _____ %

I by signing below agree to comply with all applicable City of Napoleon Codes & Ordinances while performing the work herein described. I understand that all work for which a permit is issued is required to be approved by the building inspector of the City of Napoleon.
Applicant Signature Kevin Bucher Date 7/21/05

225 -
Building 87,500
Elec 20 circuits
Plumbing - 9 traps
Mec - 8 RUNS
Sewer - 87 each -
Water - 1" meter only 1" main to curb.

New Home Permit

Electrical:

Size of Service 200 AMP Undergound _____ Overhead Number of New Circuits 20
PER SIDE PER SIDE

Plumbing:

Water Tap Required - Yes () No Size 1" Type of Pipe PLASTIC Water Dist. Pipe PVC

Sanitary Sewer Tap Required - Yes () No Size _____ Type of Pipe _____ Dr. Waste VT. Pipe _____

Main Building Drain Size _____ Main Vent Pipe Size _____

List Number of Plumbing Fixtures Below

Water Closets 4 Bathtubs 2 Showers 0 Lavatories 4 Kitchen Sinks 2 Disposal 2

Clothes Washer _____ Floor Drains 0 Dishwasher 2 Laundry Sink 2 Other _____

Total _____

Mechanical:

Heating Systems

Forced Air () Gravity () Hot Water () Steam () Unit Heaters () Radiant () Baseboard

Type of Fuel

() Electric Natural Gas () Propane () Wood () Coal () Solar () Geothermal Other _____

Number of Heat Zones 1 Hot Water - () One (1) Pipe () Two (2) Pipes () Series Loop

Electric Heat - Number of Circuits _____ Number of Furnaces 1 / PER Number of Hot Air Runs 8 PER SIDE
SIDE

Number of Hot Water Radiators _____ Total Heat Loss _____ Rated Capacity of Furnace/Boiler _____

Location of Equipment - () Crawl Space Floor Level () Attic () Suspended () Roof () Outside

THE CITY OF NAPOLEON

BUILDING & ZONING DEPARTMENT

255 W. RIVERVIEW

(419)592-4010

Electrical Permit

Page 1 of 1

Permit Number: EL2005-46

Printed: 7/27/2005

Property Address: 223 Garden St.

Applicant Mock Buehrer Builders
Address: P-707 Co. Rd. 16
Napoleon, OH 43545

Approval Date: 7/27/2005

Phone: 419-592-0825

Owners

Name: Mock-Buehrer Builders
Address: P707 Co Rd 16

Phone: 419-592-0825

Contractors Mock Buehrer Builders
Address: P-707 Co. Rd. 16
Napoleon, OH 43545

Phone 419-592-0825

Contractors Speiser, Tom
Address: P685 Co Rd 15
Napoleon, OH 43545

Phone 419-592-4125

Fees and Receipts:

Number	Description	Amount
FEE2005-553	circuts (Auto)	\$75.00
Total Fees:		\$75.00

Description of work to be done: New duplex

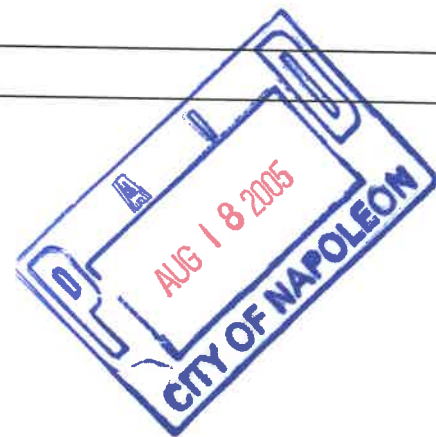

Applicant signature: _____ **Date:** _____

CITY OF NAPLES

THE CITY OF NAPOLEON

BUILDING & ZONING DEPARTMENT

255 W. RIVERVIEW

(419)592-4010

F

Inspections

Page 1 of 1

Address: 223 Garden St.
Napoleon, OH 43545

Printed: 11/23/2005

Applicant: Mock Buehrer Builders

Permit Number: EL2005-46

Inspection Date: 9/9/2005
Inspection Number: INSP2005-291
Inspection Type: Electric Rough

Inspector: Tom
Status: Approved
Passed?

Required Steps:

Comments:

Inspection Date: 9/15/2005
Inspection Number: INSP2005-292
Inspection Type: Electrical

Inspector: Tom
Status: Approved
Passed?

Required Steps:

Comments: green tagged service

Inspection Date: 11/23/2005
Inspection Number: INSP2005-421
Inspection Type: Electric Final

Inspector: Tom
Status: Complete
Passed?

Required Steps:

Comments:

Other Fields:

THE CITY OF NAPOLEON

BUILDING & ZONING DEPARTMENT

255 W. RIVERVIEW

(419)592-4010

Plumbing Permit

Page 1 of 1

Permit Number: PL2005-41

Printed: 7/27/2005

Property Address: 223 Garden St.

Applicant Mock Buehrer Builders
Address: P-707 Co. Rd. 16

Approval Date: 7/27/2005

Napoleon, OH 43545

Phone: 419-592-0825

Owners

Name: Mock-Buehrer Builders
Address: P707 Co Rd 16

Phone: 419-592-0825

Contractors Mock Buehrer Builders
Address: P-707 Co. Rd. 16
Napoleon, OH 43545

Phone 419-592-0825

Contractors Knapp Plumbing & Heating
Address: V 532 Co Rd 8
Liberty Center, OH 43532

Phone 419-875-6209

Fees and Receipts:

Number	Description	Amount
FEE2005-554	PLUMBING (Auto)	\$42.00
FEE2005-555	sewer tap (Calc)	\$87.00
FEE2005-556	Water tap & 1"meter from mai	\$880.00
FEE2005-557	sewer tap inspection fee	\$60.00

Total Fees: \$1,069.00

Description of work to be done: New duplex

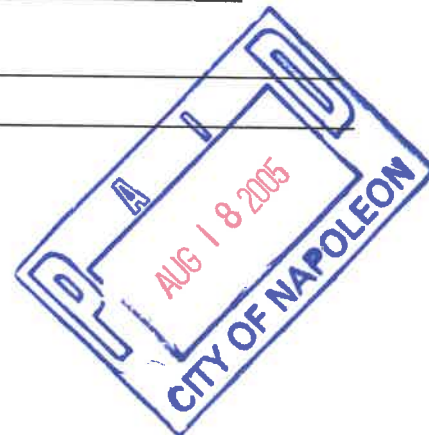

Applicant signature: _____ **Date:** _____

THE CITY OF NAPOLEON

BUILDING & ZONING DEPARTMENT

255 W. RIVERVIEW

(419)592-4010

F

Inspections

Page 1 of 1

Address: 223 Garden St.

Printed: 11/23/2005

Napoleon, OH 43545

Applicant: Mock Buehrer Builders

Permit Number: PL2005-41

Inspection Date: 9/9/2005

Inspector: Tom

Inspection Number: INSP2005-293

Status: Approved

Inspection Type: Plumbing Rough

Passed?

Required Steps:

Comments:

Inspection Date: 11/23/2005

Inspector: Tom

Inspection Number: INSP2005-422

Status: Complete

Inspection Type: Plumbing Final

Passed?

Required Steps:

Comments:

Other Fields:

THE CITY OF NAPOLEON

BUILDING & ZONING DEPARTMENT

255 W. RIVERVIEW

(419)592-4010

Mechanical Permit

Page 1 of 1

Permit Number: MC2005-56

Printed: 7/27/2005

Property Address: 223 Garden St.

Applicant Mock Buehrer Builders
Address: P-707 Co. Rd. 16

Approval Date: 7/27/2005

Napoleon, OH 43545

Phone: 419-592-0825

Owners

Name: Mock-Buehrer Builders
Address: P707 Co Rd 16

Phone: 419-592-0825

Contractors Mock Buehrer Builders
Address: P-707 Co. Rd. 16
Napoleon, OH 43545

Phone 419-592-0825

Contractors Knapp Plumbing & Heating
Address: V 532 Co Rd 8
Liberty Center, OH 43532

Phone 419-875-6209

Fees and Receipts:

Number	Description	Amount
FEE2005-558	NEW HEATING SYSTEM (Aut	\$26.00
Total Fees:		\$26.00

Description of work to be done: New duplex

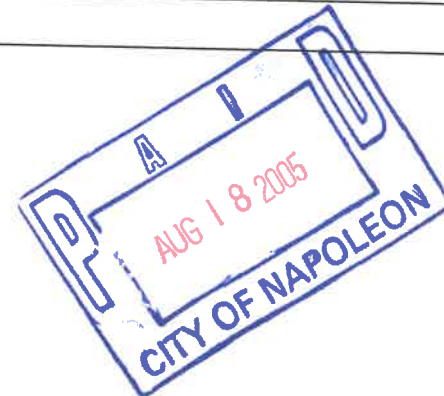

Applicant signature: _____ **Date:** _____

THE CITY OF NAPOLEON

BUILDING & ZONING DEPARTMENT

255 W. RIVERVIEW

(419)592-4010

F

Inspections

Page 1 of 1

Address: 223 Garden St.

Printed: 11/23/2005

Napoleon, OH 43545

Applicant: Mock Buehrer Builders

Permit Number: MC2005-56

Inspection Date: 9/9/2005

Inspector: Tom

Inspection Number: INSP2005-294

Status: Approved

Inspection Type: Mechanical Rough

Passed?

Required Steps:

Comments:

Inspection Date: 11/23/2005

Inspector: Tom

Inspection Number: INSP2005-423

Status: Denied

Inspection Type: Mechanical Final

Passed?

Required Steps:

Comments:

Other Fields:

New Home Permit

Electrical:

Size of Service 200 AMP PER SIDE Underground _____ Overhead Number of New Circuits 20
PER SIDE

Plumbing:

Water Tap Required - Yes () No Size 1" Type of Pipe PLASTIC Water Dist. Pipe PVC
Sanitary Sewer Tap Required - Yes () No Size _____ Type of Pipe _____ Dr. Waste VT. Pipe _____
Main Building Drain Size _____ Main Vent Pipe Size _____

List Number of Plumbing Fixtures Below

-2

Water Closets 4 Bathtubs 2 Showers 0 Lavatories 4 Kitchen Sinks 2 Disposal 2
Clothes Washer _____ Floor Drains 0 Dishwasher 2 Laundry Sink 2 Other _____
Total _____

Mechanical:

Heating Systems
 Forced Air () Gravity () Hot Water () Steam () Unit Heaters () Radiant () Baseboard

Type of Fuel
() Electric Natural Gas () Propane () Wood () Coal () Solar () Geothermal Other _____

Number of Heat Zones 1 Hot Water - () One (1) Pipe () Two (2) Pipes () Series Loop

Electric Heat - Number of Circuits _____ Number of Furnaces 1 / PER SIDE Number of Hot Air Runs 8 PER SIDE

Number of Hot Water Radiators _____ Total Heat Loss _____ Rated Capacity of Furnace/Boiler _____

Location of Equipment - () Crawl Space Floor Level () Attic () Suspended () Roof () Outside

1. The location of the service must be approved by the City Electric Distribution Superintendent before work is started. All meters shall be located so as to be exposed and accessible from the outside of the structure.

2. It is the responsibility of the builder to furnish and have installed the following:

- | | |
|--|---|
| (A) Copper entrance cable or single copper conductor in conduit from the weatherhead to the fused | (F) Ground wire |
| (B) disconnect in accordance with the following table. The size and capacity of the cable or conductors and conduit shall be maintained uniformly between the weatherhead and the fused disconnect. Neutral shall be identified by white marking or baring of insulation at end. | (G) Acorn ground rod clamps |
| (C) Weatherhead | (H) Ground rod |
| (D) Cable or conduit clamps spaced a maximum of 18" apart | (J) Watertight connector |
| | (K) Conduit bushing |
| | (L) Watertight fused disconnect |
| | (M) Pole - round or square, 12' above grade, 3' minimum in ground. (where applicable a taller or shorter pole may be acceptable.) |
| | (N) Guy wire or brace where required |
| | (P) Anchor where required |
| | (Q) Watertight GFCI protected outlet |

3. The City will furnish and the builder is to obtain and have installed the meter base. The center of the meter base shall be located 5' above finished grade.

4. The City will furnish and install the meter and necessary service lines to provide 120/240 volt single phase service from the transformer to the weatherhead.

5. Article 210-8 National Electric Code:
 (b) Construction Sites. All 120 Volt single phase 15 and 20 Amp receptacle outlets which are not a part of the permanent wiring of the building or structure shall have ground fault circuit interrupters for personnel protection.

6. If a city electric pole exists on the same side of the road where the permanent service will be located, the temporary service may be attached to it in lieu of setting a pole if approved by the Electric Distribution Superintendent.

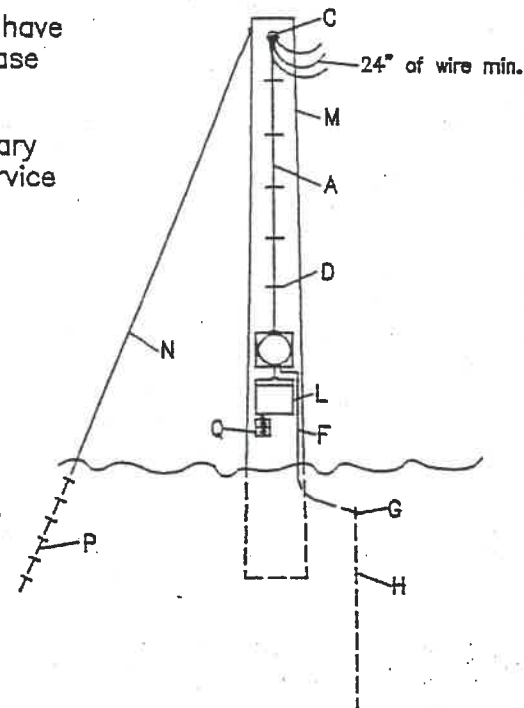
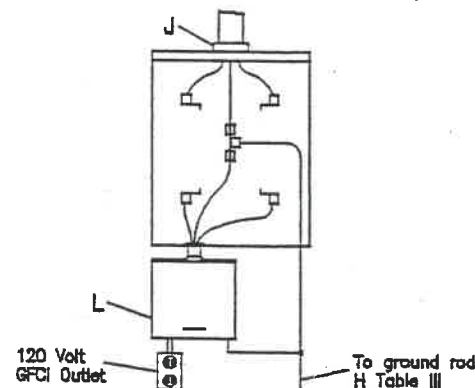

TABLE III

ITEM		SERVICE CAPACITY (AMP)	
		60	100
A	Copper Cond. S E U Cable	No. 6	No. 2
F	Bare Copper Ground Wire	No. 6	No. 6
H	1 Ground Rods 5/8" x 8' Copperweld or Galvanized		

*All material and construction shall be in accordance with the latest edition of the National Electrical Code, NFPA No. 70A.



NAPOLEON POWER & LIGHT - OVERHEAD STANDARDS

DATE
8-18-92

MINIMUM TEMPORARY SERVICE SPECIFICATIONS

T1-1

1. The location of the service must be approved by the City Electric Distribution Superintendent before work is started. All meters shall be located so as to be exposed and accessible from the outside of the structure.
2. It is the responsibility of the builder to furnish and have installed the following for 200 Amp service:
 - (A) Single conductor copper wire from the meter base to the service panel.
 - (B) 2 1/2" Schedule 40 PVC conduit* from meter base to a depth of 24" below grade.
 - (C) *(2 1/2 rigid galvanized steel or aluminum conduit may be required where exposed to vehicular traffic)
 - (D) Conduit clamps spaced a maximum of 3' apart.
 - (E) Type LB, LR, or LL fittings for all bends.
 - (F) Bare or insulated grounding conductor from the service panel grounding lug to the grounding lug within the meter socket if available. If no lug is available within the meter socket, then the grounding conductor shall be run directly to a driven ground electrode.
 - (G) Acorn Ground Rod Clamp.
 - (H) Ground Rods - spaced a minimum of 6' apart and a minimum of 18" from foundation wall.
 - (I) Locknut
 - (J) Water tight connector.
 - (K) Conduit bushing (only on galvanized and aluminum conduit).

ITEM		SERVICE CAPACITY (AMP)
		200 AMP
A	Copper Conductors	2/0 or 3/0
B	Schedule 40 PVC / Rigid Conduit Galv. Steel or Alum.	2 1/2"
F	Bare Copper Ground Wire	No. 4
H	2 Ground Rods 5/8" x 8" Copper Weld or Galvanized	

- The builder shall also provide if required:
- (1) Enough sand for 6" backfill when rock is present.
 - (2) Conduit and bushings or duct under driveways as required.
 - (3) Clearing of obstructions from the path of underground route.
3. The City will furnish and the builder is to obtain and have installed the meter base. The center of the meter base shall be located 5' above final grade.
 4. The City Electrical Inspector will inspect and approve the installation before it is put into service.
 5. The City will furnish and install the meter. The City will provide the trench, backfilling one time, and all service conductors from the transformer to the meter to provide a maximum of 200 amp, 120/240 volt single phase service, at the prices for underground services currently in effect.

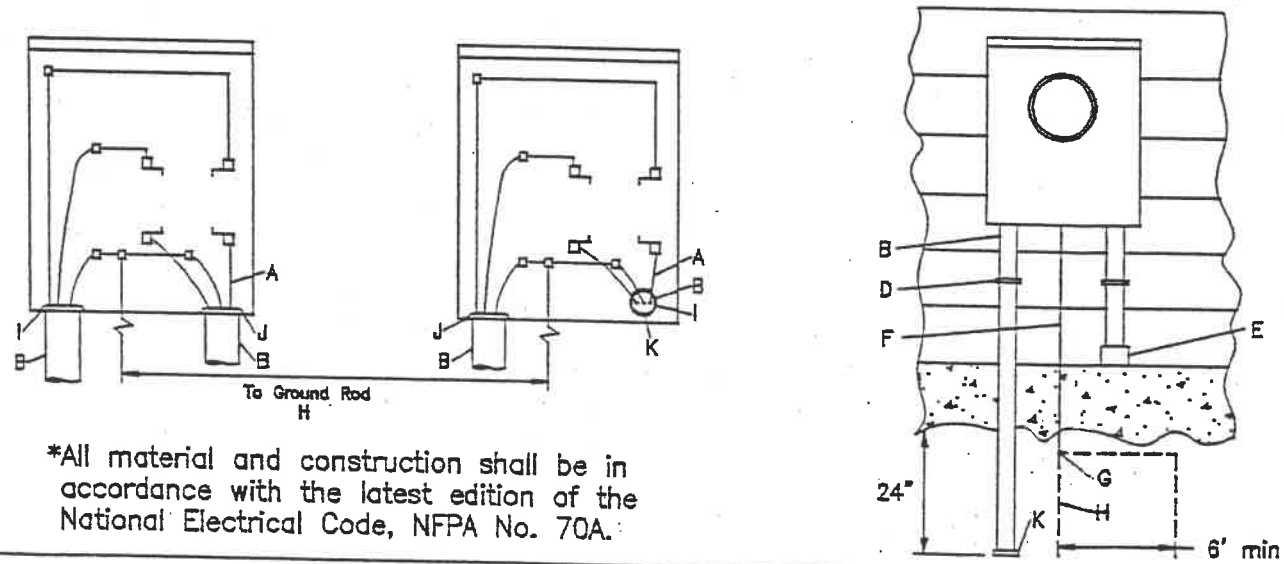

*All material and construction shall be in accordance with the latest edition of the National Electrical Code, NFPA No. 70A.

NAPOLEON POWER & LIGHT - OVERHEAD STANDARDS

PROPER ATTIC VENTILATING FOR NORTHWEST OHIO

1. The first step is to determine the total gross attic floor area.
 - a. For roof pitch 0 to 6/12 measure the total gross attic floor area.
 - b. For roof pitch over 6/12 measure the total gross attic floor area then add 10%.
2. For each one hundred (100) square feet of gross attic floor area, you will need one (1) square foot of free vent area.
3. The roof peak shall be vented at 40% of the total free area needed, either at the ridge (with proper ridge vent) or on the roof surface no more than three (3) feet down from the ridge.
4. The soffit shall be vented at 60% of the total free area needed using a louvered or perforated material.

VENTING MATERIAL NET FREE AREA FIGURES.

- A. Aluminum or vinyl perforated soffit material: One lineal foot = 10 sq. in. of free air.
- B. Plastic mesh ridge vent material: One lineal foot = 18 sq. in. of free air.*
- C. Narrow high profile aluminum ridge vent material: One lineal foot = 9 sq. in. of free air.*
- D. Wide low profile aluminum or plastic ridge vent material: One lineal foot = 18 sq. in. of free air.*
* (based on a total ridge opening of 2 1/2").

EXAMPLE:

1. Gross attic floor area = 1500 sq. ft.
2. Each one hundred (100) sq. ft. of attic floor area constitutes one (1) sq. ft. of free vent area.
3. 1500 divided by 100 = 15 sq. ft. free vent area.
4. Convert sq. ft. to sq. in. 15 multiplied by 144 (sq. in. in a sq. ft.) = 2160 sq. in.
5. 40% of 2160 sq. in. used at peak (864 sq. in.) / 60% of 2160 sq. in. used at soffit (1296 sq. in.)
6. Using mesh at peak at 18 sq. in. per lineal foot = 48 feet of material needed.
7. Using perforated soffit material at 10 sq. in. per lineal foot = 130 feet of material.

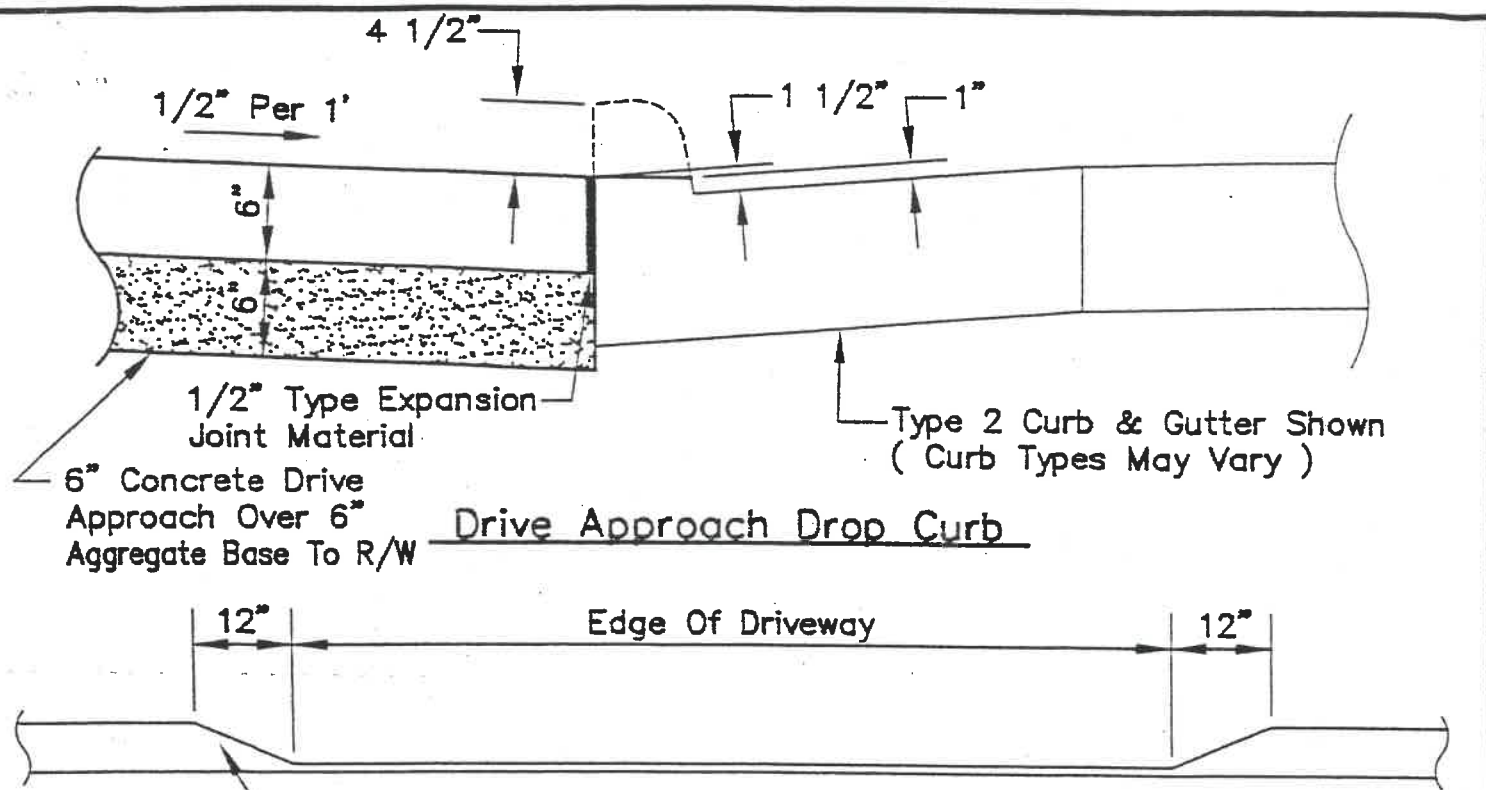

Drive Approach Drop Curb

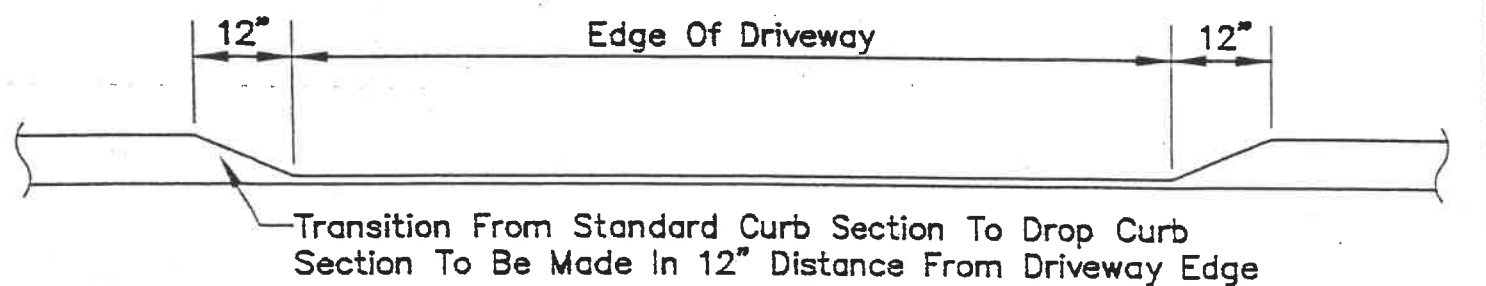

Drop Curb Section

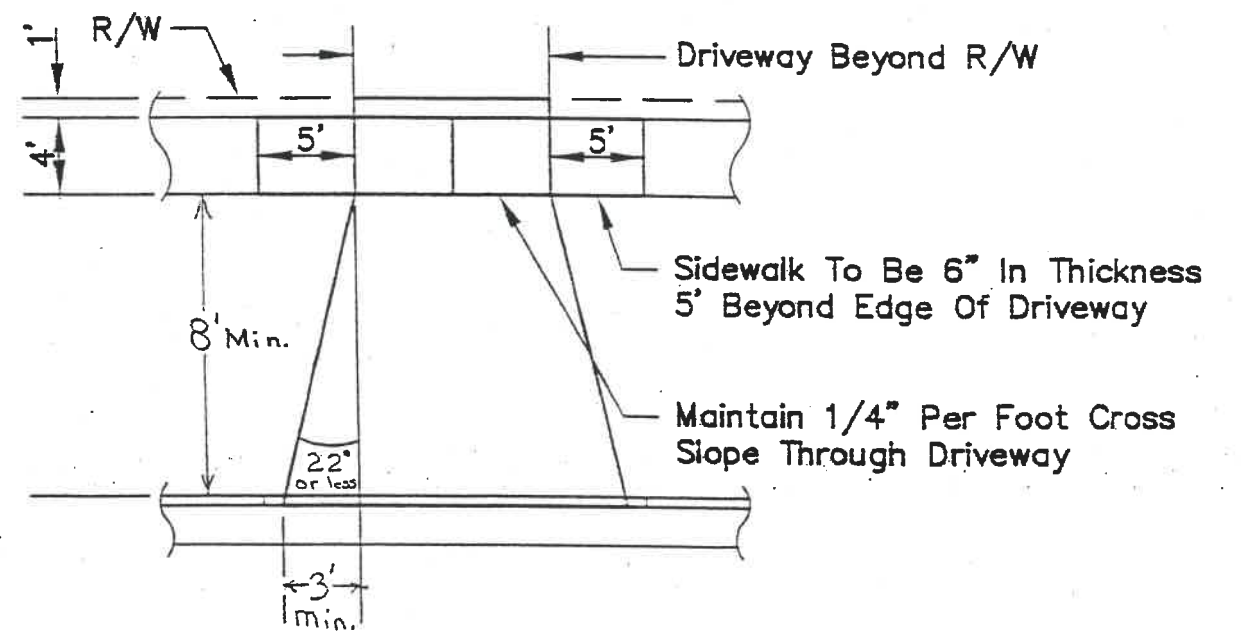

Concrete Drive Approach

* Any Variance From Detail To Be Approved By City Of Napoleon Engineering Department *

<p>CITY OF NAPOLEON ENGINEERING DEPARTMENT PO BOX 151 / 255 W. RIVERVIEW AVE. NAPOLEON, OHIO 43545 PHONE NO. (419) 592-4010 FAX NO. (419) 599-8393</p>	<p>Drive Approach And Drop Curb Standard Detail</p>	<p>DATE: 10/27/98 DRAWN BY: M.B.S. APPROVED BY: A.C.H. SCALE: NTS SHEET ___ OF ___</p>
--	---	--

CITY OF NAPOLEON

RESIDENTIAL SIDEWALK SPECIFICATION

I. WORK INCLUDED:

- A. Under this item the Contractor shall improve by construction, reconstruction or repairing as is necessary public sidewalks between limits established by the Engineer.
- B. Sidewalks shall be at least four (4") inches in thickness and in driveway crossings six (6") inches in thickness. When sidewalks abutt with the curb, the width shall be five (5') feet or as wide as the existing sidewalks; in either case, a minimum width of four (4') feet shall be adhered to. Edge of walks adjacent to the property line of the street shall be placed at least one (1') foot from the property line or meet existing sidewalks. The Engineering Department will give line and grade.
- C. Old concrete sidewalk material shall be removed and granular material used for fill if necessary to meet grade.
- D. All work shall conform to the standard specifications published by the Ohio Department of Transportation (O.D.O.T.) and the City, in effect at the date of contract and the requirements under these specifications.
 1. Referenced O.D.O.T. specifications as follows:
 - 608. concrete walks
 - 499. concrete
 - 511.12 depositing and curing concrete in cold weather

II. MATERIALS AND FINISH:

- A. A minimum 3" thick #10 crushed limestone base shall be provided and compacted in place.
- B. The concrete mix shall be a minimum of a 6' bag mix with 5 to 6% air entrainment. All surface area shall be broom finished and sealed with an Engineer approved concrete sealer. All joints shall be trowel-cut with a maximum joint spacing of 5 feet. The depth of cut shall be a minimum $\frac{1}{2}$ of the thickness of the slab. The final trowel-cut and edging shall be done after the final brooming. Expansion joints shall be placed at a maximum of 40 feet and at all intersecting walks.

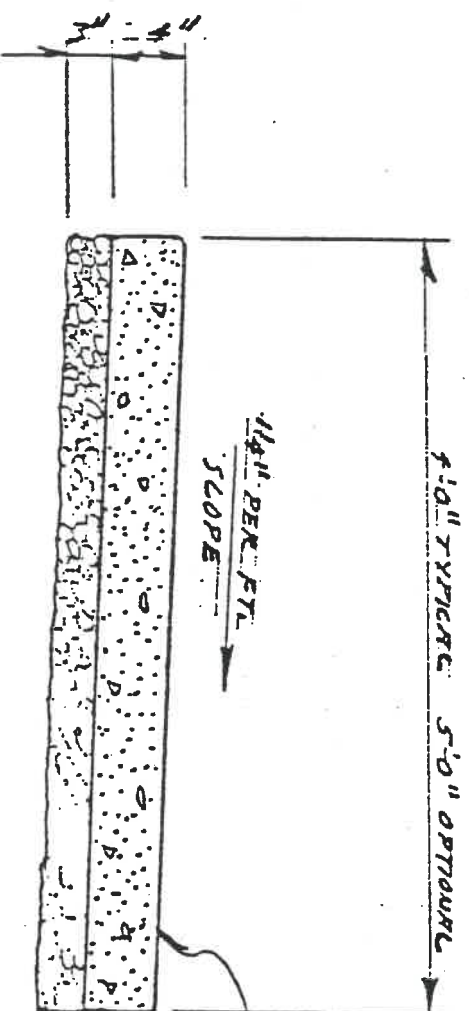

4" CONCRETE WALK
5" MIN. THICKNESS
UNDER DRIVEWAYS

MIN. 3" THICK COMPACTED
#10 CRUSHED LIMESTONE
BASE

SIDEWALK SECTION

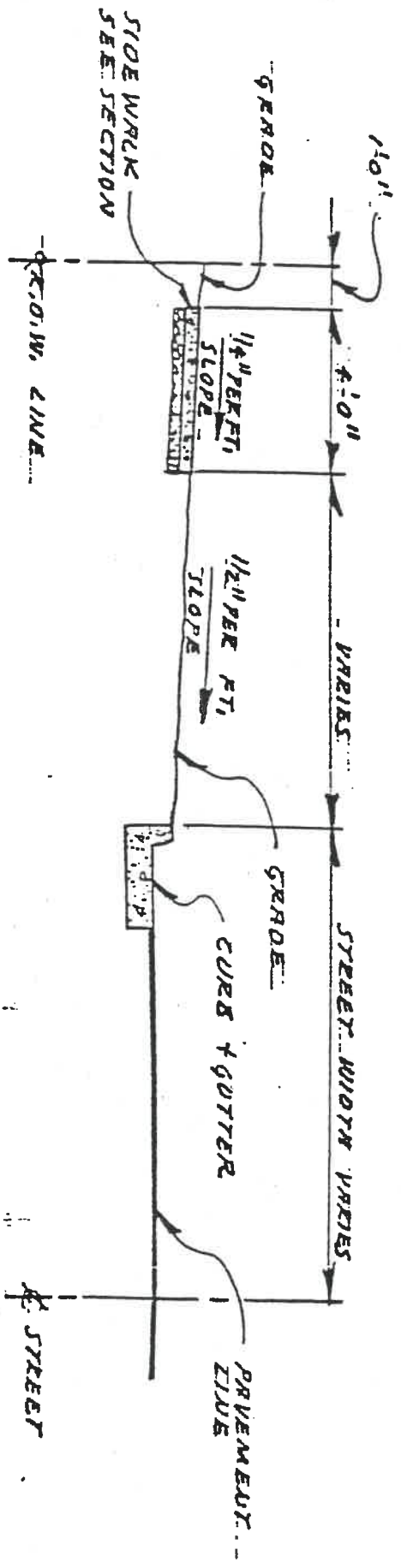

SIDEWALK LINE & ELEVATION DET.



CITY OF NAPOLEON

ELECTRIC METER BASE RELEASE FORM

THIS DOCUMENT ENTITLES THE HOLDER TO "ONE" ELECTRIC METER BASE

(Please pickup at the City Operations Garage 1775 Industrial Drive)

Permit # EL2005-46

Date Issued: 07/27/05

**Job Location: 223 Garden St.
Work Description New build**

**Owner: Mock Buehrer Builders
Address P707 Co Rd 16
Owner Phone: 419-592-0825**

**Contractor :Self
Contractor Phone:**

Electric Service Upgrade: _____ New Service Installation:

Industrial: _____ Commercial: _____ Residential: 1 Phase: _____ 3 Phase: _____

Size of Service: 100 Amp: _____ 150 Amp: _____ 200 Amp: 400 Amp: _____ Other: _____

Hub Size: 1 1/4" _____ 1 1/2" _____ 2"

Desired Voltage: 120/240: Other: _____

Underground Service: _____ Overhead Service: _____

Date Completed: _____ Approved By: _____

Old Meter Number: _____ New Meter Number: _____

Comments: _____



CITY OF NAPOLEON

WATER METER YOKE RELEASE FORM

THIS DOCUMENT ENTITLES THE HOLDER TO "ONE" WATER METER YOKE ASSEMBLY
(Please pickup at City Operations Department 1775 Industrial Drive.)

Permit Number: BP2005-113

Date Issued: 07/27/05

Job Location: 223 Garden St.

Owner: Mock Buehrer Builders
Address: P-707 Co Rd 16
Phone: 419-592-0825

Contractor: Mock Buehrer Builders
Phone: 419-592-0825

Water Tap Size: 1" 1 1/2" 2" Other: _____
Water Meter Yoke Size: 5/8" 3/4" 1" Other _____
New Structure: Existing Structure: Lawn Meter:

WATER SERVICE LINE TO BE TYPE "K" COPPER OR "CTS"
POLYETHELENE TUBING OF 1" MINIMUM SIZE.

Backflow Device Required?: Yes No

Type of Backflow Required: _____

Water Meter Yoke Installation is subject to the following conditions:

1. Must be located in an accessible area.
2. Must be in an area which is not subject to freezing temperatures.
3. Must be at least 18" above floor level (no crawl space installations.)
4. Must comply with minimum mounting requirements (drawings available).

Issued By: _____ Received By: _____

1 Copy to : Building Dept, Water Dept, and Utilities Dept.

THE CITY OF NAPOLEON

BUILDING & ZONING DEPARTMENT

255 W. RIVERVIEW

(419)592-4010

F

Inspections

Page 1 of 1

Address: 223 Garden St.
Napoleon, OH 43545

Printed: 11/23/2005

Applicant: Mock Buehrer Builders

Permit Number: BP2005-113

Inspection Date: 7/27/2005	Inspector: Tom
Inspection Number: INSP2005-289	Status: Approved
Inspection Type: Footer	Passed? <input checked="" type="checkbox"/>

Required Steps:

Comments:

Inspection Date: 9/9/2005	Inspector: Ohio
Inspection Number: INSP2005-290	Status: Approved
Inspection Type: Framing	Passed? <input checked="" type="checkbox"/>

Required Steps:

Comments:

Inspection Date: 9/21/2005	Inspector: Tom
Inspection Number: INSP2005-312	Status: Closed
Inspection Type: Driveway	Passed? <input checked="" type="checkbox"/>

Required Steps:

Comments:

Inspection Date: 11/9/2005	Inspector: Tom
Inspection Number: INSP2005-400	Status: Approved
Inspection Type: Sidewalk	Passed? <input checked="" type="checkbox"/>

Required Steps:

Comments:

Inspection Date: 11/23/2005	Inspector: Tom
Inspection Number: INSP2005-420	Status: Complete
Inspection Type: Building Final	Passed? <input checked="" type="checkbox"/>

Required Steps:

Comments:

Other Fields:

Inside Residential Detail
5/8", 3/4", Or 1" Meter

Dual Check Valve Assembly
 Backflow Preventer
 (Mounted Horizontal)

Note:
 New Meter Installation In
 Crawl Spaces, Will Not Be
 Accepted. Noncompliance Will
 Result In No Issuance Of
 Occupancy Permit.

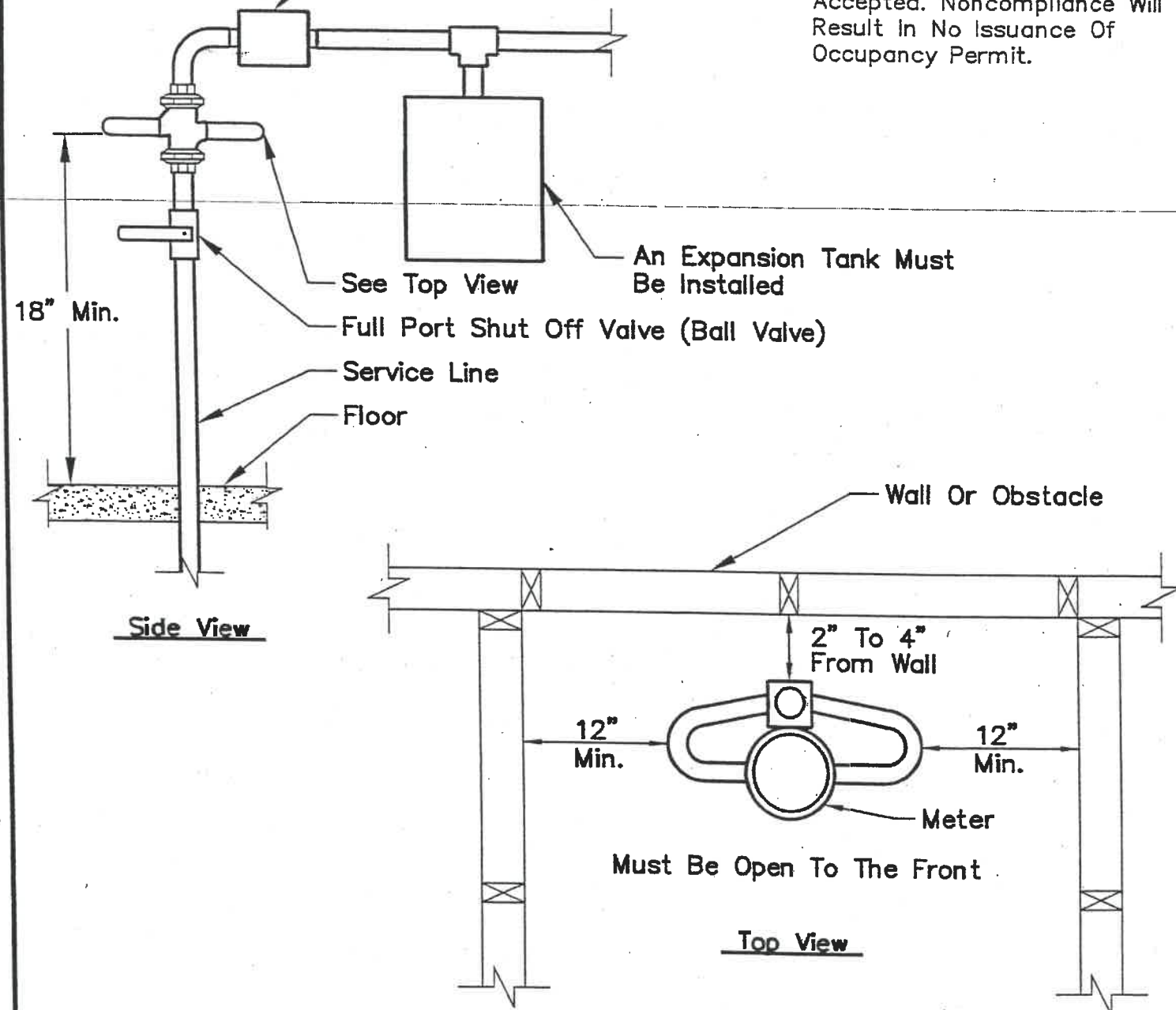

CITY OF NAPOLEON
 ENGINEERING DEPARTMENT
 PO BOX 151 / 255 W. RIVERVIEW AVE.
 NAPOLEON, OHIO 43545
 PHONE NO. (419) 592-4010
 FAX NO. (419) 599-8393

City Of Napoleon
 Water Distribution Dept.
 Typ. Service Installation

DATE: 04/07/99
 DRAWN BY: M.B.S.
 APPROVED BY: J.C.M.
 SCALE: NTS
 SHEET ___ OF ___

THE CITY OF NAPOLEON
BUILDING & ZONING DEPARTMENT
255 W. RIVERVIEW
(419)592-4010

Certificate of Occupancy

11/23/2005

Address: 223 Garden St.
Napoleon, OH 43545

Permit #: BP2005-113

Issued: 11/23/2005
Mock-Buehrer Builders
P707 Co Rd 16
Napoleon, OH 43545

Substantial qualifications of occupancy

This certificate is issued by the City Building Inspector, as completed substantially in conformity with the approved plans and permission is hereby granted to occupy such building in compliance with such legal use and occupancy as authorized under the provisions of the ordinances of the City of Napoleon.

This is a valuable record for owner or lessee and should be so preserved.

By: Tom Zimmerman

Signature:  _____

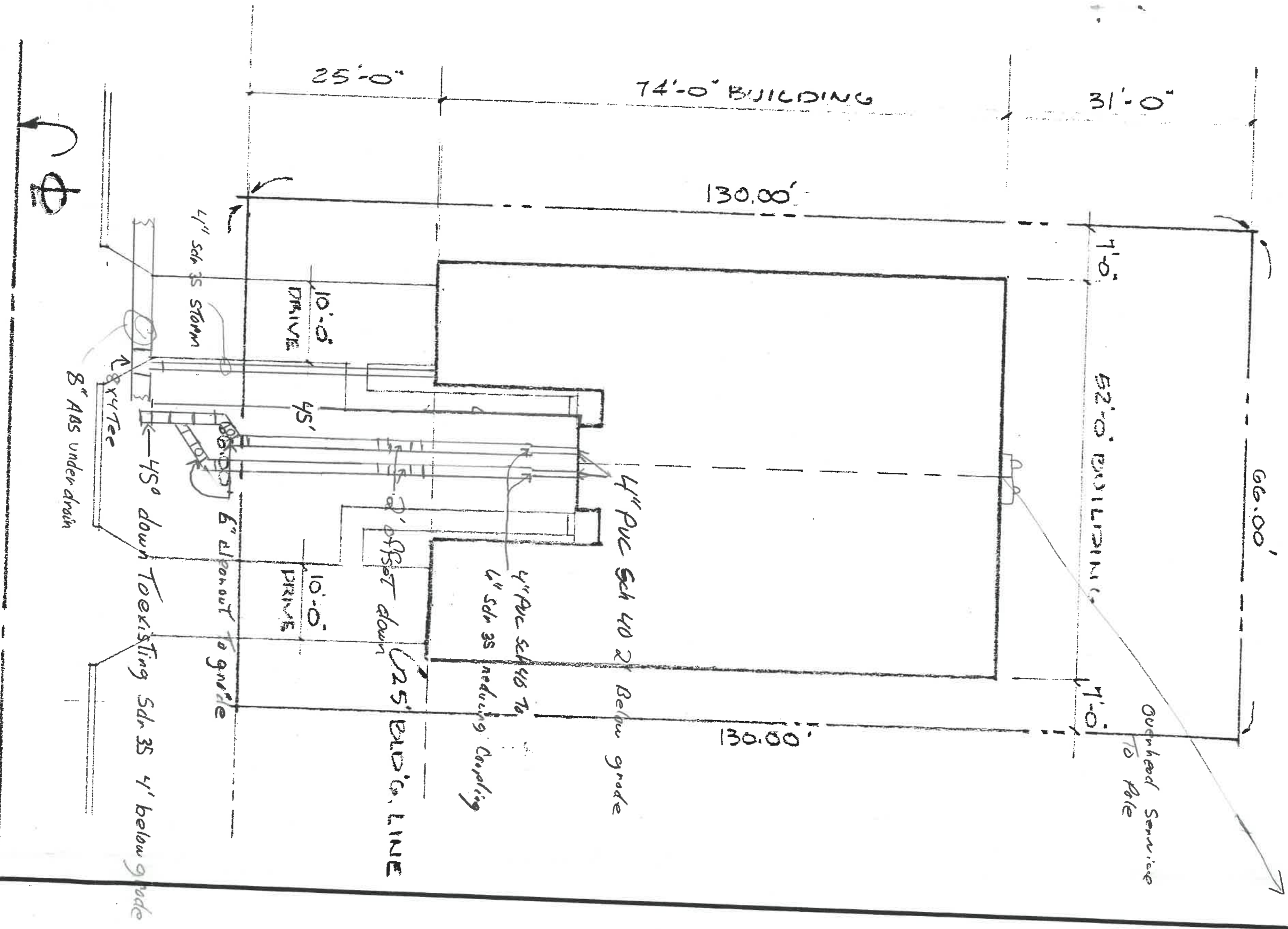

PLOT PLAN
 SCALE 1"=20'-0"

